

CONTENTS

- A. Rescue Tales™ Pomeranian (1)
- B. Backpack Carrying Case
- C. Blanket
- D. Food Bowl

- E. Dog Treats Bag
- F. Removable Mirror
- G. Comb
- H. Collar

- I. Donut Dog Toy
- J. Barrettes (3)
- 1 Bow
- 2 Ice Cream Cones

REMOVE FROM PACKAGING

To remove the product from the packaging, twist and move all 4 locks that secure the product to the package. They are located underneath the unit. Discard these locks before giving the product to a child.

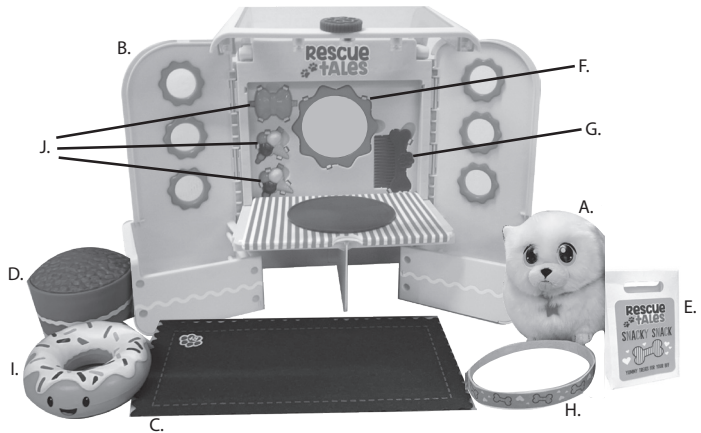
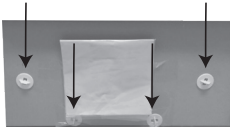

NAME YOUR PET & SIGN THE ADOPTION CERTIFICATE



Write your pet's name on the label and stick the label to the dog's tag on the collar.

Sign your pet's adoption certificate.



Illustrations are for reference only. Styles may vary from actual contents.

Please remove all packaging including tags, ties and tacking stitches before giving this product to a child.

QUICK PLAY

Barrettes: Use the bow and ice cream cone barrettes to accessorize your pup after its visit to the groomer.

Removable Mirror: Let your pup admire themselves in the mirror after you're done styling its hair. Mirror easily separates from the backpack.

Styling Turntable: Place your pup on the turntable to get to each part of your pup's fur. See below for additional instructions on use.

Comb: Grooming comb easily separates from the backpack. Comb your pup's fur while you play dog groomer.

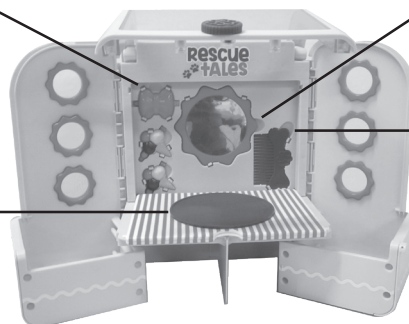

STYLING TURNTABLE SET UP

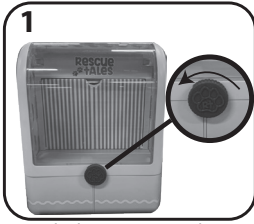

1 To unlock, turn paw to the left until it will no longer turn.

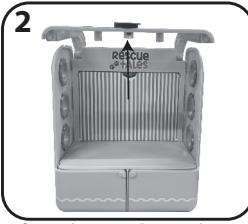

2 Lift overhang and extend. Adjust the back portion of the overhang so it stays open by pushing down until level.



3 Place finger in crescent cut out located on grooming station back wall.



4 Use crescent cut out to pull back wall down until laying flat. Once the styling turntable is set up, you will be able to access all accessories to begin grooming your toy.

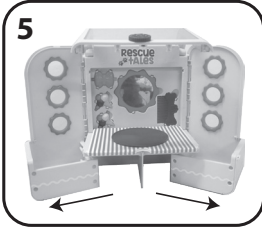

5 For more room and additional storage space, expand your station by pulling out both side walls. NOTE: The overhang will need to be adjusted once expanded.

ON THE GO

When play time is over pack up all of your grooming station accessories and place them in your backpack.

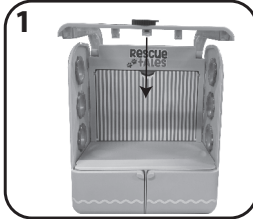

1 Lift and pull overhang forward to close lid. NOTE: Watch your fingers when closing.

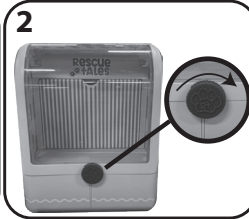

2 To lock, turn paw to the right until it will no longer turn. NOTE: Be sure to line up lock properly before turning to ensure backpack is secured prior to lifting or carrying.



3 Once you are ready to put your backpack on make sure to adjust the straps of your backpack, pull the nylon straps and slide the buckles up or down for a proper fit.

IMPORTANT INFORMATION

- Illustrations are for reference only. Styles may vary from actual contents.
- Do not apply the name tag label to other surfaces, as it may not be completely removed.
- Do not use water or submerge toy under water.
- Do not adjust straps too tightly.
- Toy and accessories are not meant to be used on live animals.

Please keep this manual as it contains important information.



© The Little Tikes Company, an MGA Entertainment company. LITTLE TIKES® and RESCUE TALES™ are trademarks of Little Tikes in the U.S. and other countries. All logos, names, characters, likenesses, images, slogans, and packaging appearance are the property of Little Tikes.

Printed in China • 0321-1-E



www.littletikes.com
www.littletikes.co.uk
www.littletikes.com.au

Little Tikes Consumer Service
2180 Barlow Road
Hudson, Ohio 44236 U.S.A.
1-800-321-0183

MGA Entertainment UK Ltd.
50 Presley Way, Crownhill, Milton
Keynes, MK8 0ES, Bucks, UK
support@LittleTikesStore.co.uk
Tel: +0 800 521 558

MGA Entertainment (Netherlands) B.V.
Baronie 68-70, 2404 XG Alphen a/d Rijn
The Netherlands
Tel: +31 (0) 172 758038

**Imported by MGA Entertainment
Australia Pty Ltd**
Suite 2.02, 32 Delhi Road
Macquarie Park NSW 2113
1300 059 676